

Inceput proiect
Str. Zavoiului
Km 0+000.00

Sfarsit proiect
Str. Zavoiului
Km 0+116.00

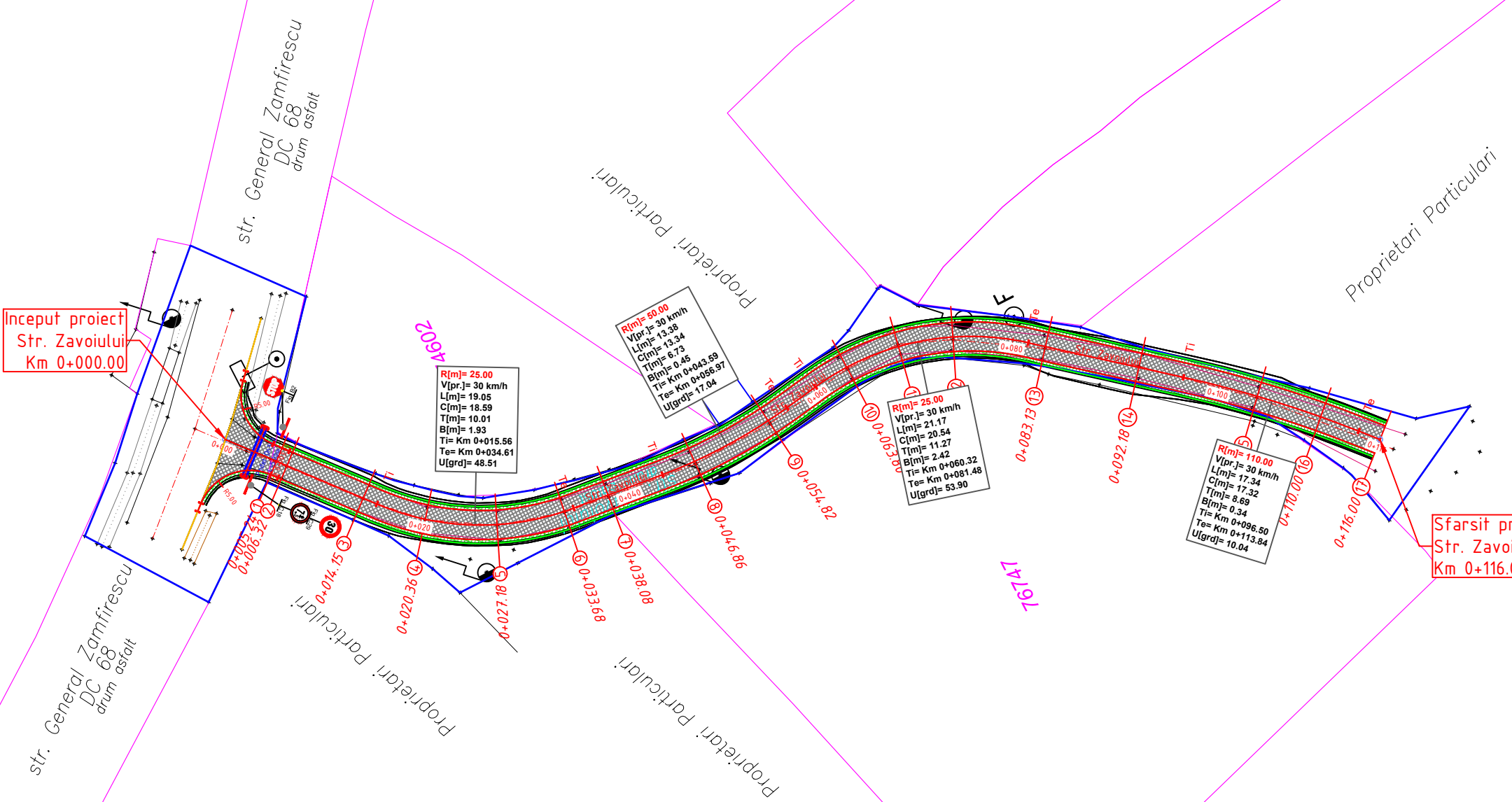

| | | | | | | | | | | | |
|------------------------|------|-----------|---------|---|--|---|---|----------------------------------|--|--|-----------------------|
| | | | | Proiectant General: S.C. GLOBAL ENGINEERING CONSULTING S.R.L. Bucuresti, Bd. Lacul Tei, nr. 123, Bl. 4, Sc.C, Et.6, Ap.117, J40/2345/2007, CUI 20986394 | | | Beneficiar: COMUNA POTLOGI, JUDETUL DAMBOVITA | | Proiect nr. 19/2022 | | |
| | | | | SPECIFICATIE SEF PROIECT PROIECTAT DESENAT | | NUME ing. A. Bolovaneanu ing. F. Bolovaneanu ing. F. Bolovaneanu | SEMNATURA | Scara: 1:500 Data: 2022 | Titlu proiect: MODERNIZARE STRAZI, COMUNA POTLOGI, JUDETUL DAMBOVITA | Faza: PT + DE | |
| VERIFICATOR/ EXPERT | NUME | SEMNATURA | CERINȚA | REFERAT / EXPERTIZA NR. / DATA | | | | | | Titlu plansa: Plan de situatie Sat. Vlasceni, Str. Zavoiului | Plansa nr. PS05-01 |

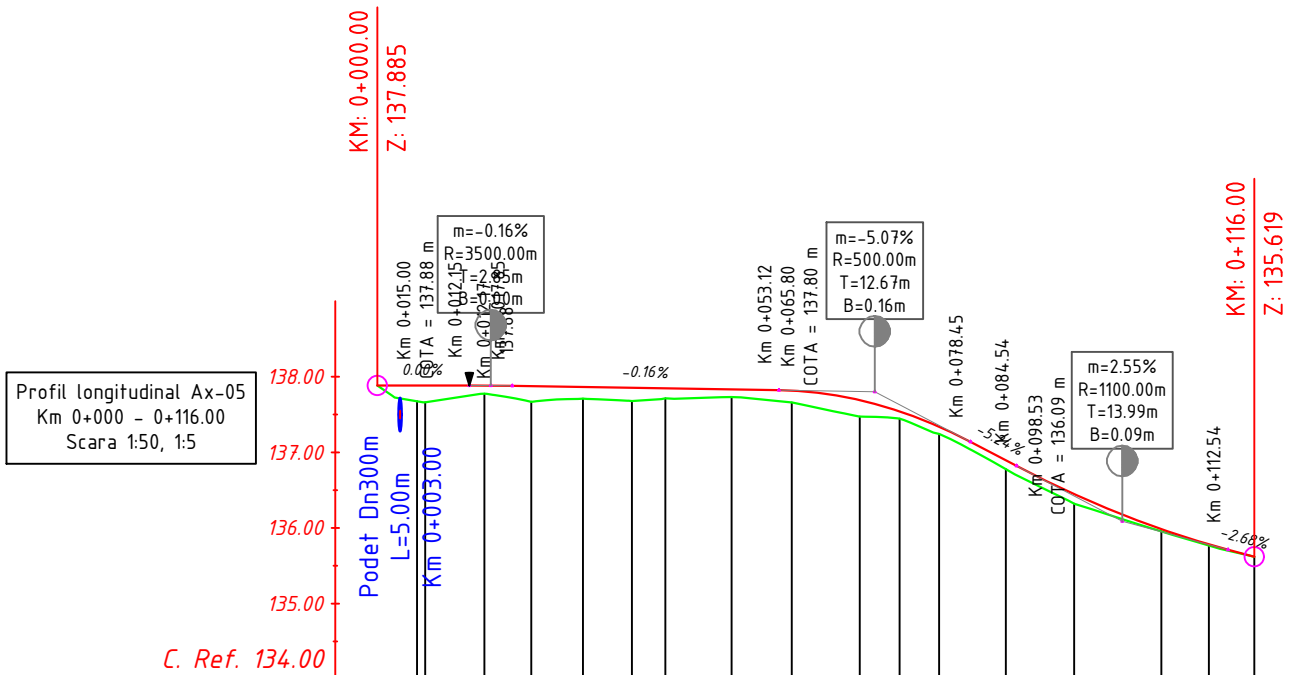

| PICHETI | 1 | 2 | 3 | 4 | 5 | 6 | 7 | 8 | 9 | 10 | 11 | 12 | 13 | 14 | 15 | 16 | 17 | |
|----------------------|---------------------|----------|-----------------------------------|----------|----------------------|----------|-----------------------------------|----------|---------------------|----------|-----------------------------------|----------|-------------------|----------|-----------------------------------|----------|----------|----------|
| KILOMETRAJ | 0+000.00 | 0+002.26 | 0+005.32 | 0+014.15 | 0+020.36 | 0+027.18 | 0+033.68 | 0+038.08 | 0+046.86 | 0+054.82 | 0+063.80 | 0+069.07 | 0+074.30 | 0+083.13 | 0+092.18 | 0+103.70 | 0+110.00 | 0+116.00 |
| DIFERENTE AX | 0.00 | 0.16 | 0.22 | 0.11 | 0.21 | 0.15 | 0.18 | 0.13 | 0.10 | 0.16 | 0.22 | 0.10 | 0.10 | 0.12 | 0.13 | 0.03 | 0.02 | 0.00 |
| COTE TEREN | 137.88 | 137.73 | 137.68 | 137.78 | 137.67 | 137.71 | 137.68 | 137.71 | 137.73 | 137.66 | 137.47 | 137.45 | 137.24 | 136.78 | 136.32 | 135.96 | 135.77 | 135.62 |
| COTE PROIECT | 137.88 | 137.88 | 137.88 | 137.88 | 137.86 | 137.85 | 137.85 | 137.83 | 137.82 | 137.69 | 137.54 | 137.34 | 136.89 | 136.45 | 135.98 | 135.78 | 135.62 | 135.62 |
| ALINIAMENTE SI CURBE | L=15.56m | | R=25.00m L=19.05m U=151.43 | | L=8.98m | | R=50.00m L=13.38m U=182.96 | | L=3.34m | | R=25.00m L=21.17m U=146.10 | | L=15.02m | | R=110.00m L=17.34m U=189.96 | | L=2.16m | |
| DECLIVITATI | L=12.15m m=0.00% | | R=3500.00m L=5.69m m=-0.16% | | L=35.28m m=-0.16% | | R=500.00m L=25.33m m=-5.07% | | L=8.09m m=-5.24% | | R=1100.00m L=27.99m m=2.55% | | L=4.6m m=2.68% | | | | | |

Profil longitudinal Ax-05
Km 0+000 - 0+116.00
Scara 1:50, 1:5

| | | | | | | |
|---|---------------------|--------------------|---|--|------------------------|-----------------------|
| Proiectant General: S.C. GLOBAL ENGINEERING CONSULTING S.R.L. Bucuresti, Bd. Lacul Tei, nr. 123, Bl. 4, Sc.C, Et.6, Ap.117, J40/2345/2007, CUI 20986394 | | | Beneficiar: COMUNA POTLOGI, JUDETUL DAMBOVITA | | Proiect nr. 19/2022 | |
| SPECIFICATIE | NUME | SEMNTATURA | Scara: 1:1000 1:100 | Titlu proiect: MODERNIZARE STRAZI, COMUNA POTLOGI, JUDETUL DAMBOVITA | | Faza: PT + DE |
| SEF PROIECT | ing. A. Bolovaneanu | <i>[Signature]</i> | Data: 2022 | Titlu plansa: Profil longitudinal Sat. Vlasceni, Str. Zavoiului | | Plansa nr. PL05-01 |
| PROIECTAT | ing. F. Bolovaneanu | <i>[Signature]</i> | | | | |
| DESENAT | ing. F. Bolovaneanu | <i>[Signature]</i> | | | | |

| VERIFICATOR/ EXPERT | NUME | SEMNTATURA | CERINȚA | REFERAT / EXPERTIZA NR. / DATA |
|---------------------|------|------------|---------|--------------------------------|
| | | | | |

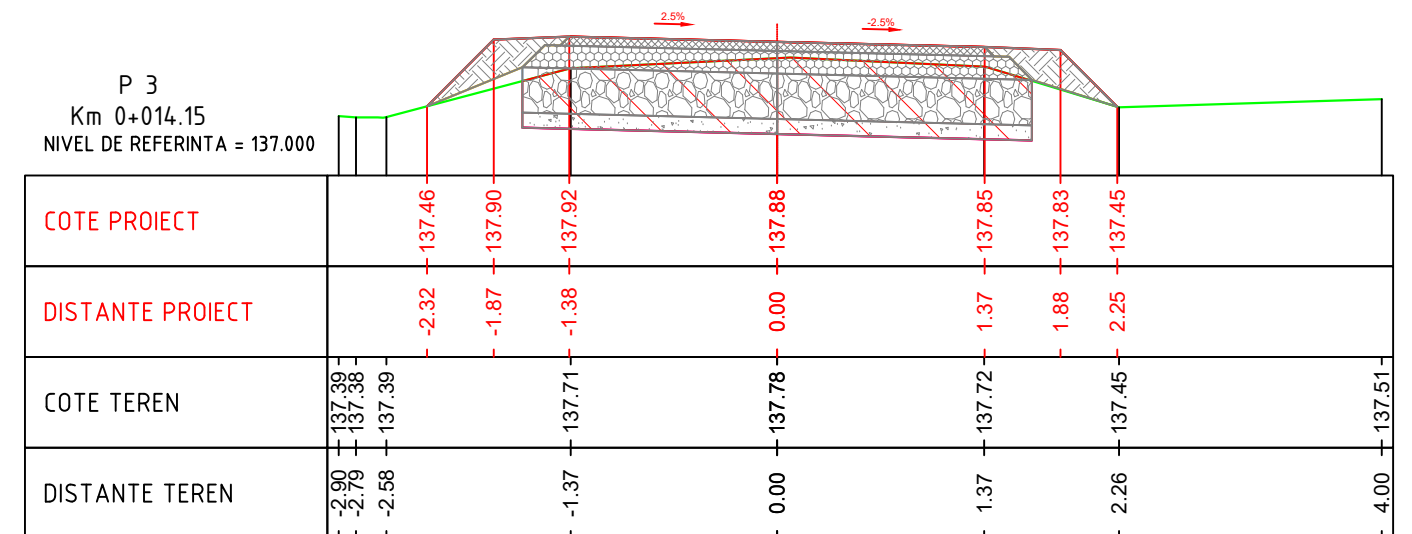
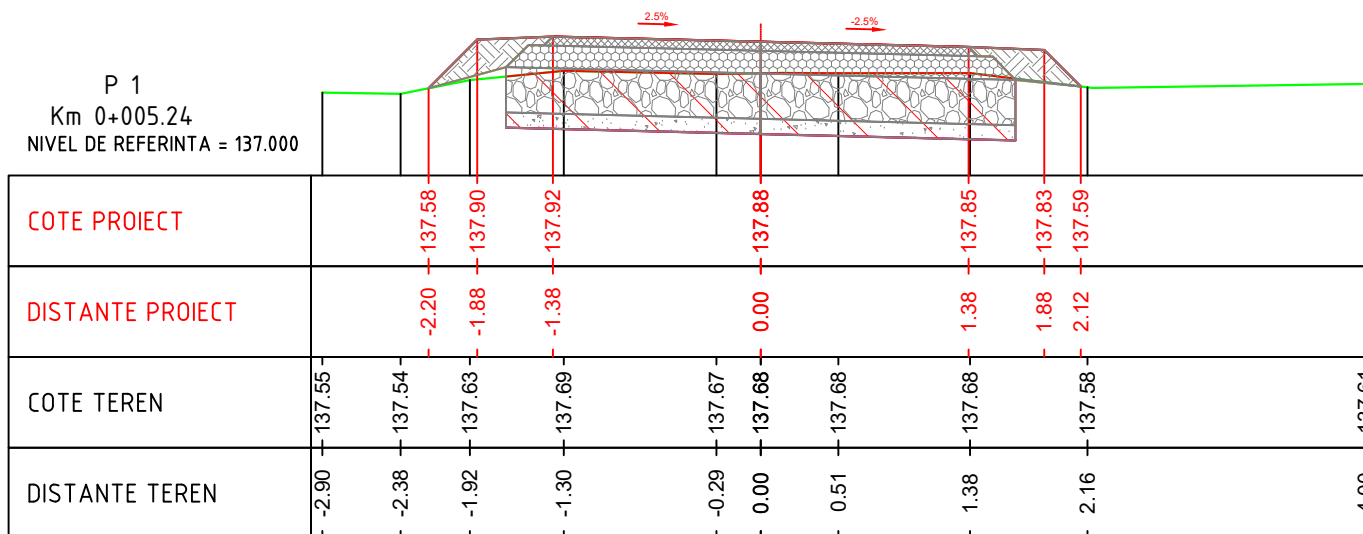
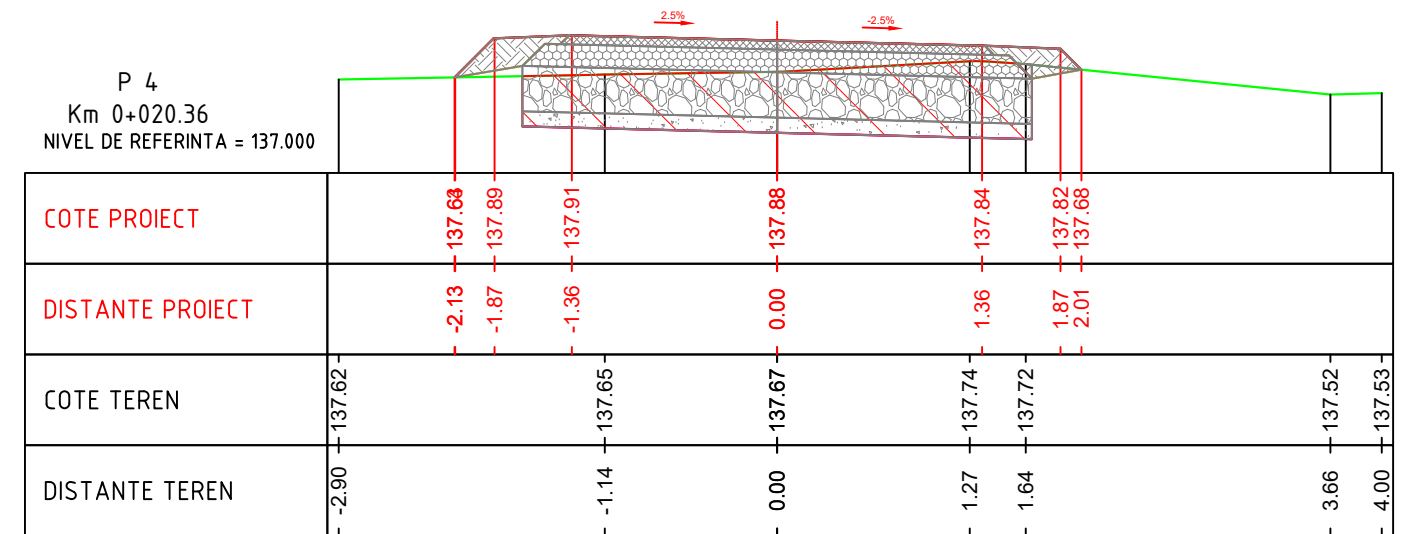
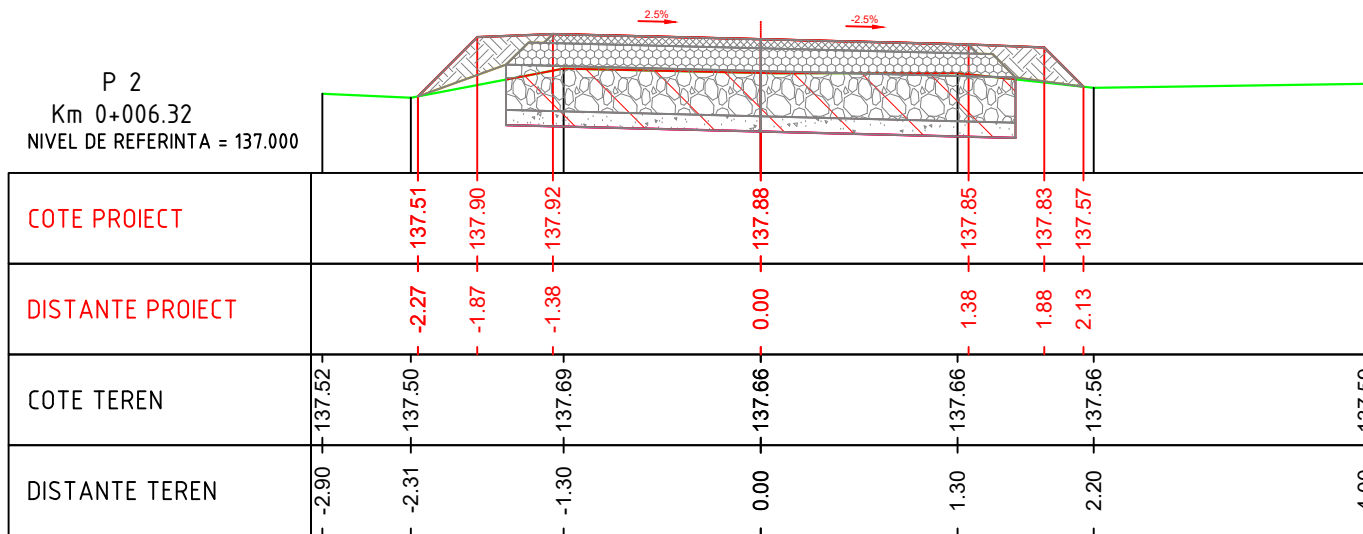

| VERIFICATOR/ EXPERT | NUME | SEMNETURA | CERINȚA | REFERAT / EXPERTIZA NR. / DATA |
|------------------------|------|-----------|---------|--------------------------------|
| | | | | |
| | | | | |

| | | | | | |
|---|--|--|---|--|------------------------|
| Proiectant General: S.C. GLOBAL ENGINEERING CONSULTING S.R.L. Bucuresti, Bd. Lacul Tei, nr. 123, Bl. 4, Sc.C, Et.6, Ap.117, J40/2345/2007, CUI 20986394 | | | Beneficiar: COMUNA POTLOGI, JUDETUL DAMBOVITA | | Proiect nr. 19/2022 |
| SPECIFICATIE SEF PROIECT PROIECTAT DESENAT | | | NUME ing. A. Bolovaneanu ing. F. Bolovaneanu ing. F. Bolovaneanu | | SEMNETURA |
| Scara: 1:50 | | | Titlu proiect: MODERNIZARE STRAZI, COMUNA POTLOGI, JUDETUL DAMBOVITA | | Faza: PT + DE |
| Data: 2022 | | | Titlu plansa: Profile transversale caracteristice Sat. Vlasceni, Str. Zavoiului | | Plansa nr. PTC05-01 |

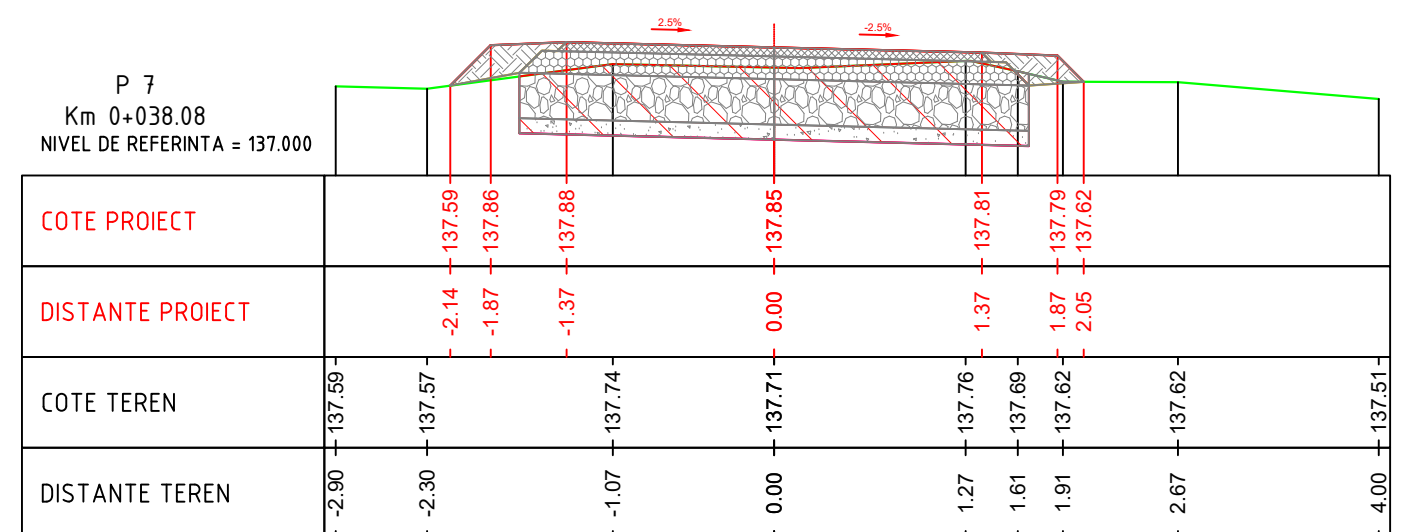
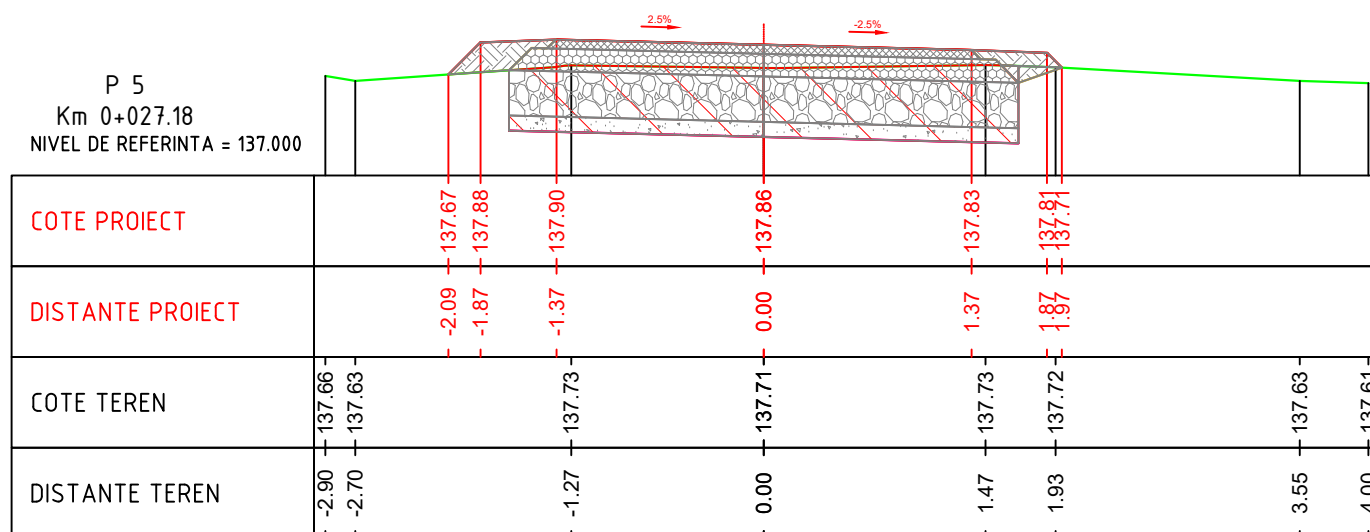
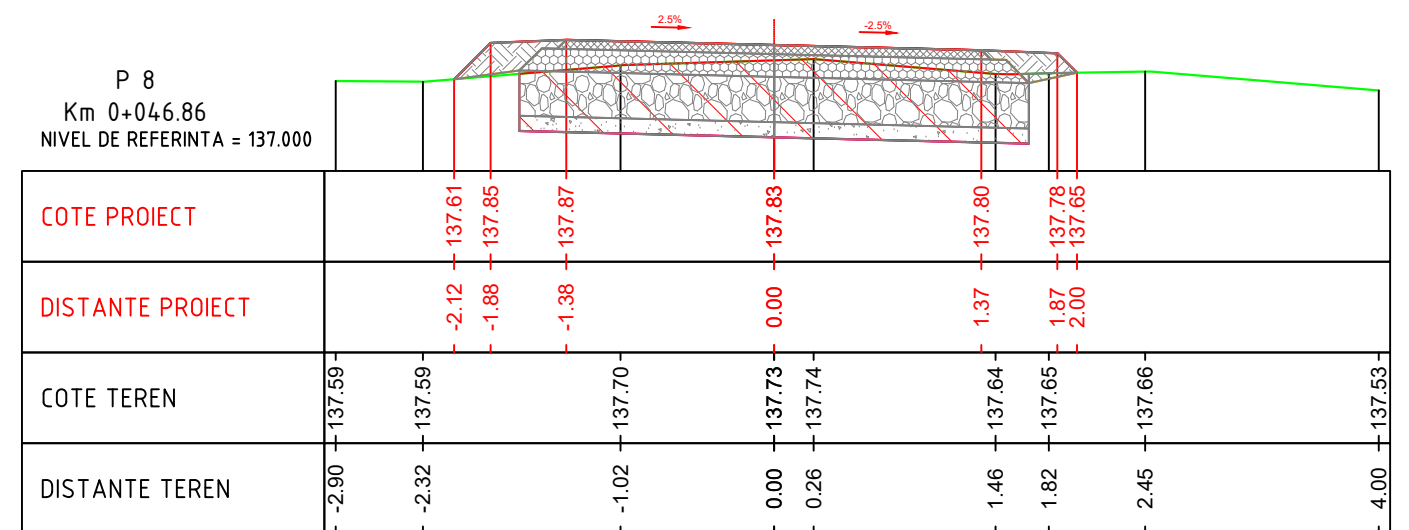
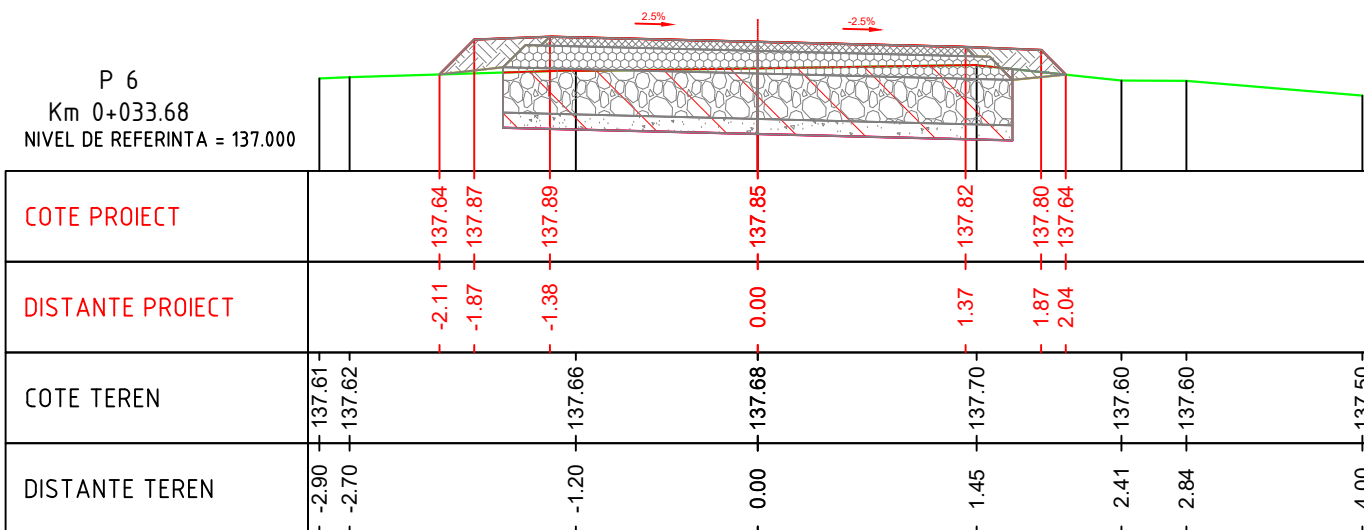

| VERIFICATOR/ EXPERT | NUME | SEMNTURA | CERINȚA | REFERAT / EXPERTIZA NR. / DATA |
|------------------------|------|----------|---------|--------------------------------|
| | | | | |
| | | | | |

| | | | | | | | |
|--|--|--|---|----------------------|---------------------------------|---|--|
| Proiectant General: S.C. GLOBAL ENGINEERING CONSULTING S.R.L. <small>Bucuresti, Bd. Lacul Tei, nr. 123, Bl. 4, Sc.C, Et.6, Ap.117, J40/2345/2007, CUI 20986394</small> | | | Beneficiar: COMUNA POTLOGI, JUDETUL DAMBOVITA | | Proiect nr. 19/2022 | | |
| SPECIFICATIE SEF PROIECT PROIECTAT DESENAT | | | NUME ing. A. Bolovaneanu ing. F. Bolovaneanu ing. F. Bolovaneanu | SEMNTURA | Scara: 1:50 Data: 2022 | Titlu proiect: MODERNIZARE STRAZI, COMUNA POTLOGI, JUDETUL DAMBOVITA Titlu plansa: Profile transversale caracteristice Sat. Vlasceni, Str. Zavoiului | Faza: PT + DE Plansa nr. PTC05-02 |

P 10
Km 0+063.80
NIVEL DE REFERINTA = 137.000

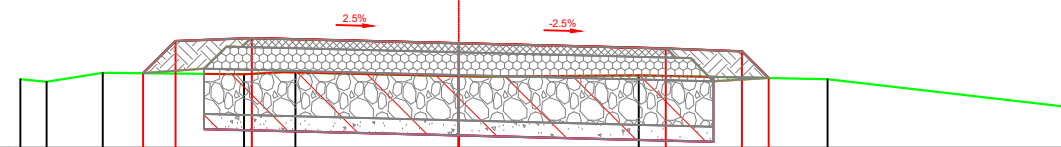

| | | | | | | | | | | |
|------------------|--------|--------|--------|--------|--------|--------|--------|--------|------|--------|
| COTE PROIECT | | | | | | | | | | |
| DISTANTE PROIECT | | -2.09 | -1.87 | -1.37 | 0.00 | | 1.37 | 1.87 | 2.05 | |
| COTE TEREN | 137.45 | 137.44 | 137.50 | 137.49 | 137.50 | 137.47 | 137.48 | 137.45 | | 137.27 |
| DISTANTE TEREN | -2.90 | -2.73 | -2.35 | -1.42 | -1.08 | 0.00 | 1.19 | 2.44 | | 4.00 |

P 12
Km 0+074.30
NIVEL DE REFERINTA = 136.000

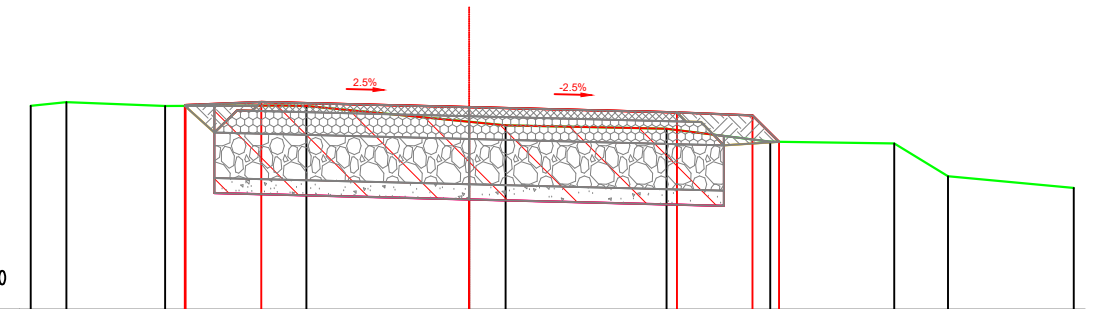

| | | | | | | | | | | |
|------------------|--------|--------|--------|--------|--------|--------|--------|--------|--------|--------|
| COTE PROIECT | | | | | | | | | | |
| DISTANTE PROIECT | | -1.88 | -1.37 | 0.00 | | 1.38 | 1.88 | 2.05 | | |
| COTE TEREN | 137.35 | 137.37 | 137.35 | 137.35 | 137.24 | 137.22 | 137.20 | 137.11 | 137.10 | 136.88 |
| DISTANTE TEREN | -2.90 | -2.66 | -2.01 | -1.08 | 0.00 | 0.24 | 1.31 | 1.99 | 2.81 | 3.17 |

P 9
Km 0+054.82
NIVEL DE REFERINTA = 137.000

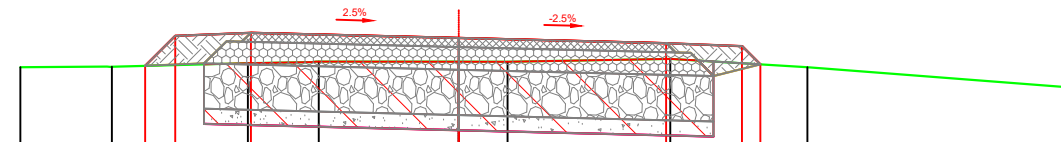

| | | | | | | | | | | |
|------------------|--------|--------|--------|--------|--------|--------|--------|--------|------|--------|
| COTE PROIECT | | | | | | | | | | |
| DISTANTE PROIECT | | -2.07 | -1.88 | -1.38 | 0.00 | | 1.37 | 1.87 | 1.99 | |
| COTE TEREN | 137.62 | 137.63 | 137.63 | 137.65 | 137.66 | 137.66 | 137.68 | 137.62 | | 137.49 |
| DISTANTE TEREN | -2.90 | -2.29 | -1.40 | -0.93 | 0.00 | 0.32 | 1.40 | 2.31 | | 4.00 |

P 11
Km 0+069.07
NIVEL DE REFERINTA = 136.000

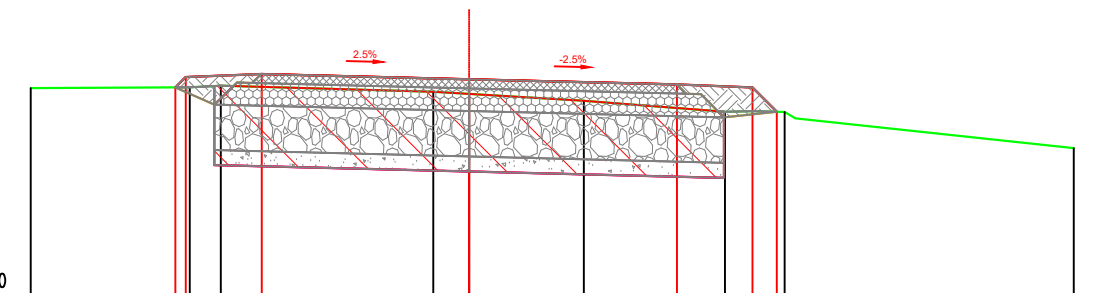

| | | | | | | | | | | |
|------------------|--------|--------|--------|--------|--------|--------|--------|--------|--|--------|
| COTE PROIECT | | | | | | | | | | |
| DISTANTE PROIECT | | -1.87 | -1.37 | 0.00 | | 1.38 | 1.88 | 2.04 | | |
| COTE TEREN | 137.48 | 137.49 | 137.50 | 137.46 | 137.45 | 137.40 | 137.33 | 137.33 | | 137.09 |
| DISTANTE TEREN | -2.90 | -1.85 | -1.64 | -0.24 | 0.00 | 0.76 | 1.69 | 2.09 | | 4.00 |

| VERIFICATOR/ EXPERT | NUME | SEMNETURA | CERINȚA | REFERAT / EXPERTIZA NR. / DATA |
|------------------------|------|-----------|---------|--------------------------------|
| | | | | |

| | | | | | | |
|---|---|-----------------------|---|--|------------------------|--|
| Proiectant General: S.C. GLOBAL ENGINEERING CONSULTING S.R.L. Bucuresti, Bd. Lacul Tei, nr. 123, Bl. 4, Sc.C, Et.6, Ap.117, J40/2345/2007, CUI 20986394 | | | Beneficiar: COMUNA POTLOGI, JUDETUL DAMBOVITA | | Proiect nr. 19/2022 | |
| SPECIFICATIE SEF PROIECT PROIECTAT DESENAT | NUME ing. A. Bolovaneanu ing. F. Bolovaneanu ing. F. Bolovaneanu | SEMNETURA | Scara: 1:50 Data: 2022 | Titlu proiect: MODERNIZARE STRAZI, COMUNA POTLOGI, JUDETUL DAMBOVITA Titlu plansa: Profile transversale caracteristice Sat. Vlasceni, Str. Zavoiului | | Faza: PT + DE Plansa nr. PTC05-03 |

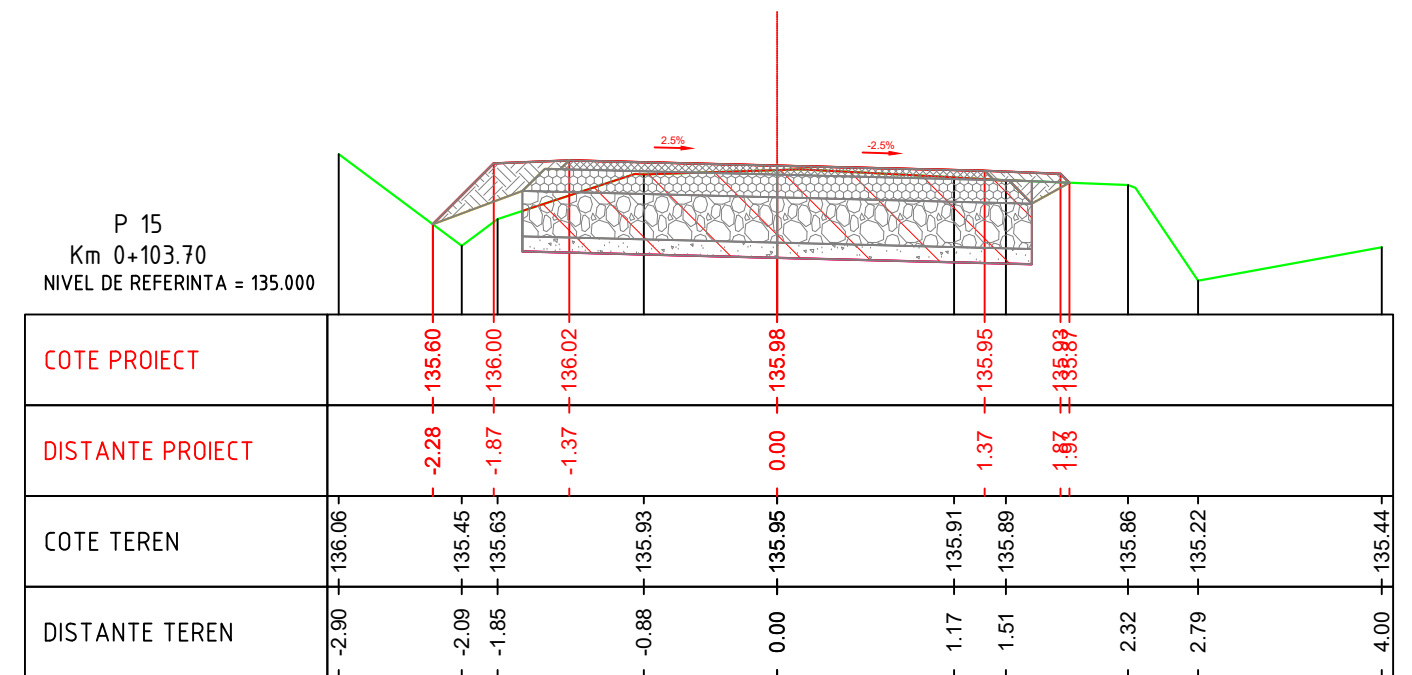
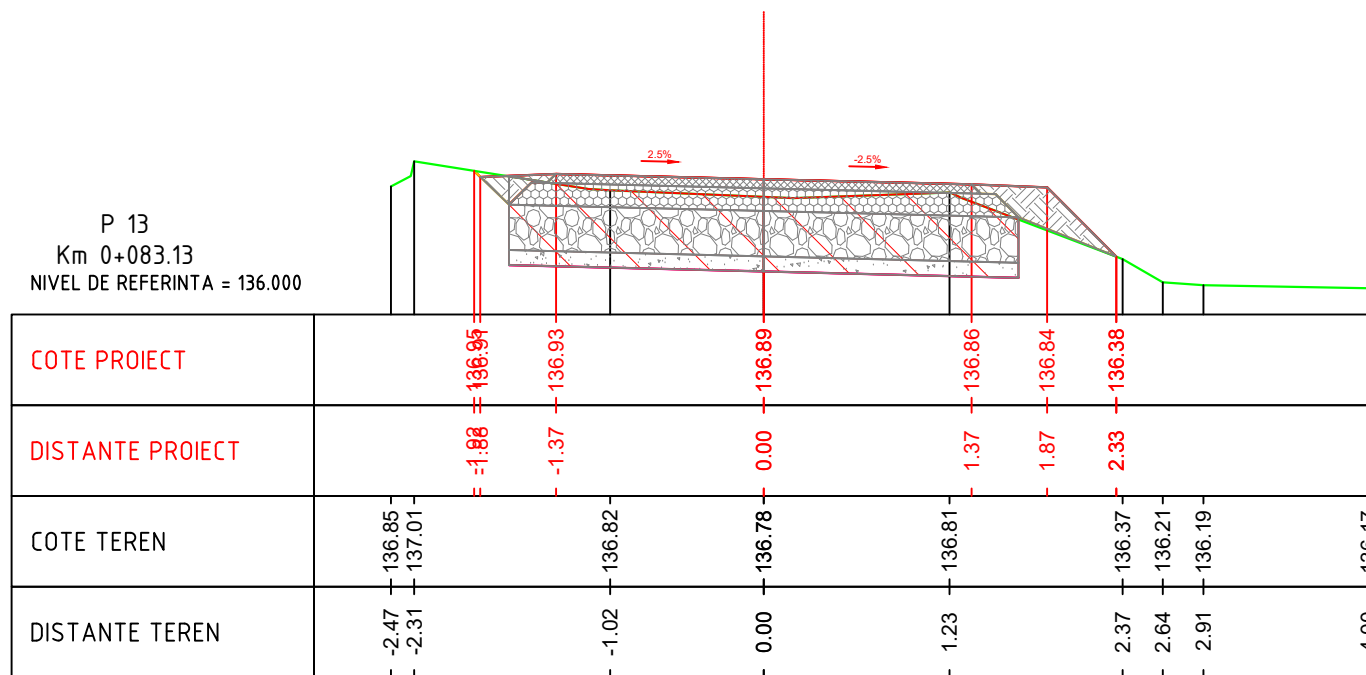
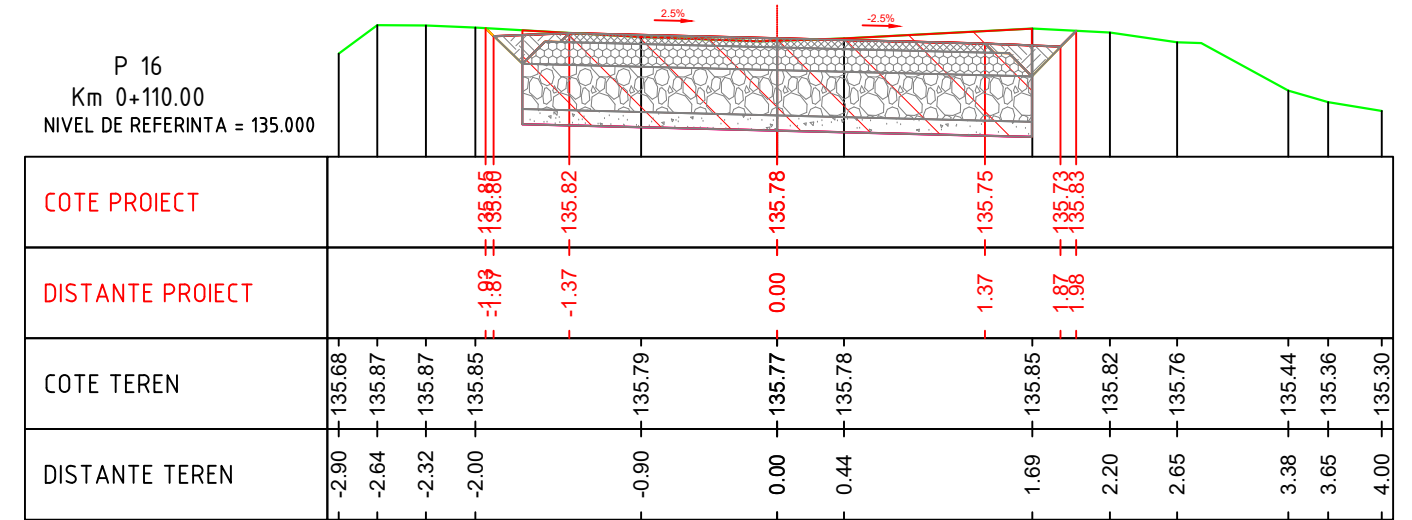
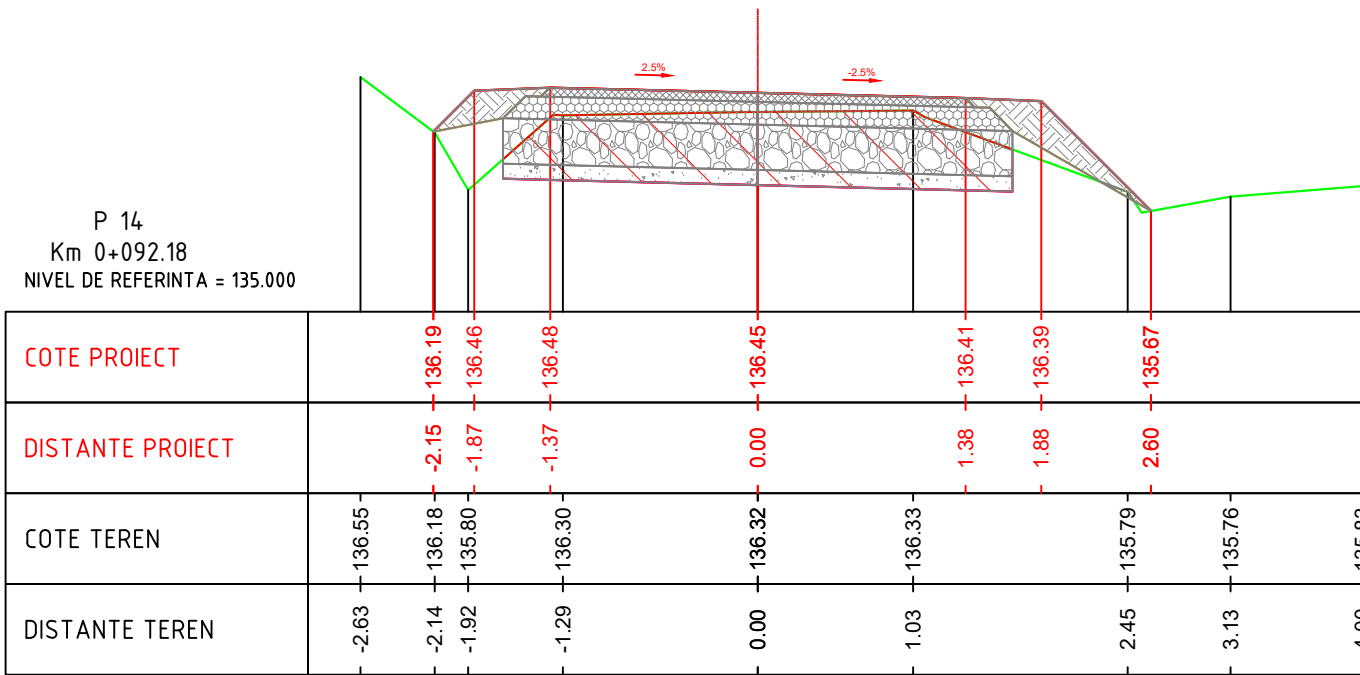

| VERIFICATOR/ EXPERT | NUME | SEMNETURA | CERINȚA | REFERAT / EXPERTIZA NR. / DATA |
|------------------------|------|-----------|---------|--------------------------------|
| | | | | |
| | | | | |

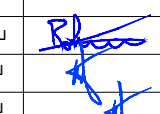
| | | | | | |
|---|--|--|---|--|--|
| Proiectant General: S.C. GLOBAL ENGINEERING CONSULTING S.R.L. Bucuresti, Bd. Lacul Tei, nr. 123, Bl. 4, Sc.C, Et.6, Ap.117, J40/2345/2007, CUI 20986394 | | | Beneficiar: COMUNA POTLOGI, JUDETUL DAMBOVITA | | Proiect nr. 19/2022 |
| SPECIFICATIE SEF PROIECT PROIECTAT DESENAT | | | NUME ing. A. Bolovaneanu ing. F. Bolovaneanu ing. F. Bolovaneanu | | SEMNETURA  |
| Scara: 1:50 | | | Titlu proiect: MODERNIZARE STRAZI, COMUNA POTLOGI, JUDETUL DAMBOVITA | | Faza: PT + DE |
| Data: 2022 | | | Titlu plansa: Profile transversale caracteristice Sat. Vlasceni, Str. Zavoiului | | Plansa nr. PTC05-04 |

P 17
 Km 0+116.00
 NIVEL DE REFERINTA = 134.000

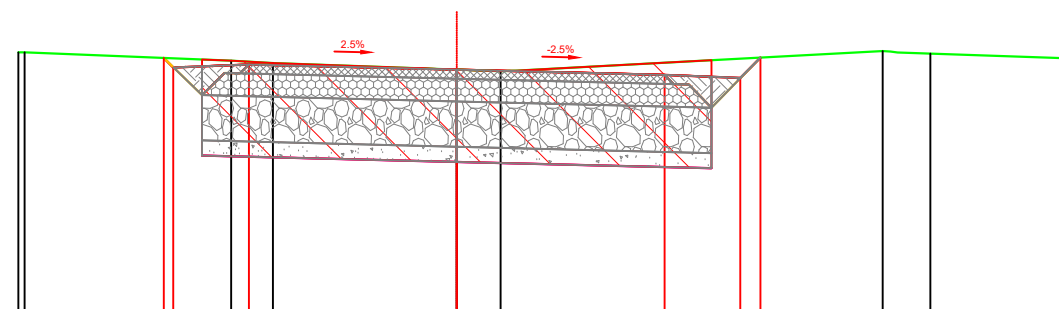

| | | | | | | | | | | |
|------------------|--|--|--|--|--|--|--|--|--|--|
| COTE PROIECT | | | | | | | | | | |
| DISTANTE PROIECT | | | | | | | | | | |
| COTE TEREN | | | | | | | | | | |
| DISTANTE TEREN | | | | | | | | | | |

| | | | | | |
|--|---------------------|--------------------|---|--|------------------------|
| Proiectant General: S.C. GLOBAL ENGINEERING CONSULTING S.R.L. <small>Bucuresti, Bd. Lacul Tei, nr. 123, Bl. 4, Sc.C, Et.6, Ap.117, J40/2345/2007, CUI 20986394</small> | | | Beneficiar: COMUNA POTLOGI, JUDETUL DAMBOVITA | | Proiect nr. 19/2022 |
| SPECIFICATIE | NUME | SEMNATURA | Scara: | Titlu proiect: | Faza: |
| SEF PROIECT | ing. A. Bolovaneanu | <i>[Signature]</i> | 1:50 | MODERNIZARE STRAZI, COMUNA POTLOGI, JUDETUL DAMBOVITA | PT + DE |
| PROIECTAT | ing. F. Bolovaneanu | <i>[Signature]</i> | Data: | Titlu plansa: Profile transversale caracteristice Sat. Vlasceni, Str. Zavoiului | Plansa nr. PTC05-05 |
| DESENAT | ing. F. Bolovaneanu | <i>[Signature]</i> | 2022 | | |

| VERIFICATOR/ EXPERT | NUME | SEMNATURA | CERINȚA | REFERAT / EXPERTIZA NR. / DATA |
|------------------------|------|-----------|---------|--------------------------------|
| | | | | |
| | | | | |
| | | | | |